

Nordic Feel

Scandinavian inspiration with love,
from

SWISSPEARL



Scandinavian architecture is marked by a focus on clean, simple lines, minimalism, and functionality without sacrificing beauty.

In this book we want to share some of our references mixing modern techniques and vernacular aesthetics to create spaces perfectly tuned for inhabitants who crave more than what meets the eye.

And of course with a little touch of Danish "hygge".

Hope you enjoy!





Vigtil Terrasse Trondheim, Norway

Architect: Per Knudsen
Arkitektkontor
Type: Residential
Year: 2019
Category: Facade
Product: Swisspearl Patina Rough
P 070



IKEA Hotell Älmhult, Sweden

Architect: Arkitekterna Krook &
Tjäder Uulas

Type: Hotel

Year: 2016

Category: Facade

Product: Swisspearl Patina Original P 222

Skibladnersvingen Eidsvoll, Norway

Architect: Stein Halvorsen Arkitekter

Type: Residential

Year: 2017

Category: Facade

Product: Cembrit Transparent T 242 (discontinued)
and Solid S 030

Equivalent products: Carat & Zenor



Visionshuset Aalborg, Denmark

Architect: KPF Arkitekter
Type: Office
Year: 2011
Category: Facade
Product: Swisspearl Patina Original P 070





Kåkenästet – Stenungsund, Sweden

Architect: Mats & Arne Arkitektkontor

Type: Private housing

Year: 2018

Category: Facade

Product: Solid S 212 and Cembrit W 146-8 light grey

Equivalent product to Solid: Zenor



Plus Bolig Aalborg, Denmark

Architect: KPF Arkitekter

Type: Office

Year: 2016

Category: Facade

Product: Swisspearl Patina Original

P 050, P 070 and P 222



Mælumenga Terrasse Buskerud, Norway

Architect: Arkitektgruppen Drammen

Type: Residential

Year: 2018

Category: Facade

Product: Swisspearl Patina Original
P 050 and P 222



Kvarteret Hunden Luleå, Sweden

Architect: Strategisk Arkitektur

Type: Hotel and office

Year: 2013

Category: Facade

Product: Swisspearl Patina Original P 222

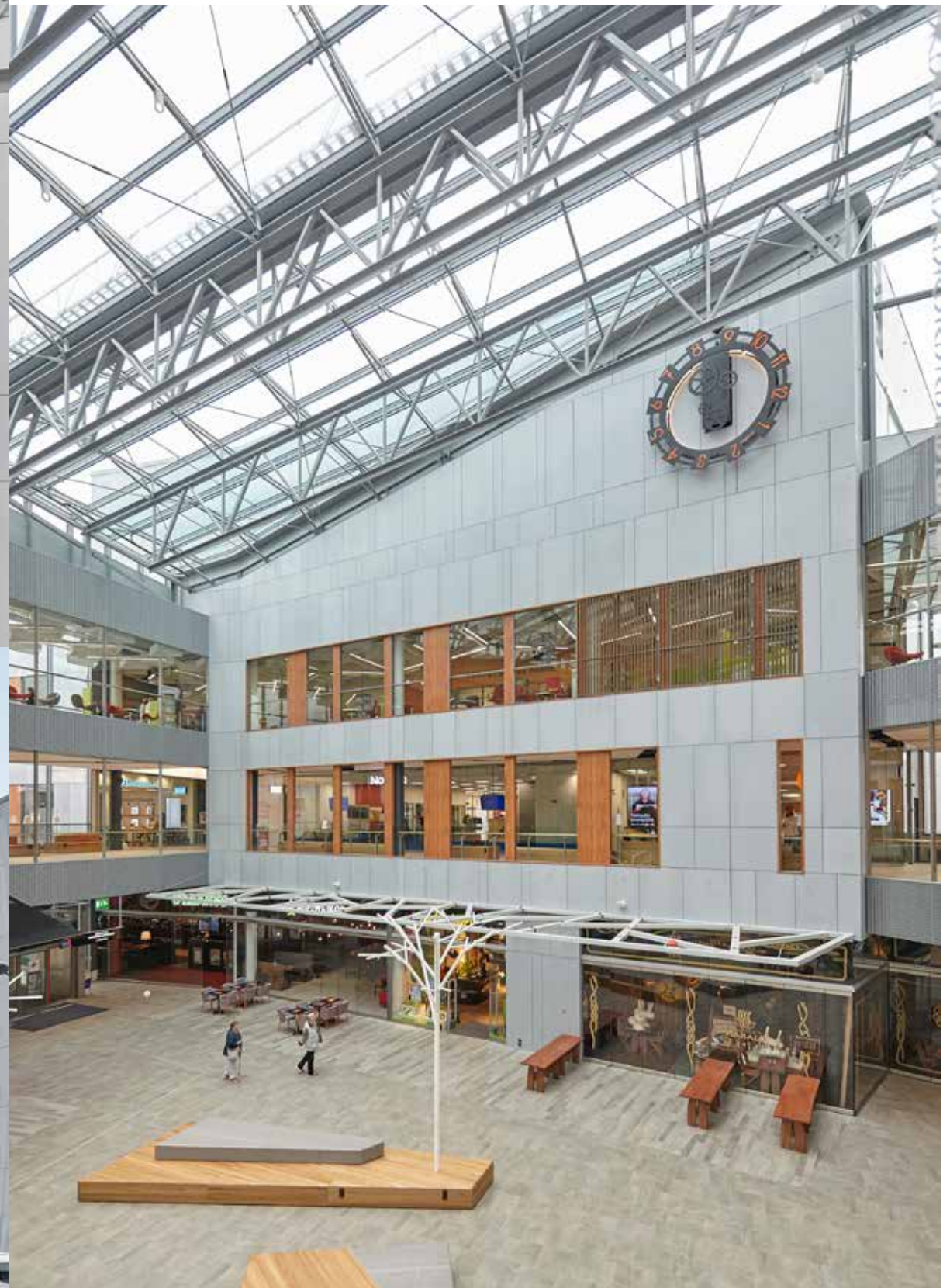

Kauppakeskus Iso Omena Espoo, Finland

Architect: Arkkitehtitoimisto HKP

Type: Public

Year: 2016

Category: Facade

Product: Swisspearl Patina Original P 020



Flygfältet shopping Norrtälje, Sweden

Architect: Reflex Arkitekter

Type: Public

Year: 2012

Category: Facade

Product: Swisspearl Patina Original P 020 and
Cembrit Cover in NCS 1500-N (discontinued)

Equivalent product: Planea



Finstad Park Akershus, Norway

Architect: Spor Arkitekter
Type: Residential
Year: 2017
Category: Facade
Product: Swisspearl Patina Original
P 020 and P 070





Villa Woldu - Mölndal, Sweden

Architect: Bornstein Lyckefors Arkitekter

Type: Private housing

Year: 2010

Category: Facade

Product: Cembrit Transparent T 242 (discontinued)

Equivalent product: Carat



Hørning Denmark

Type: Private housing

Year: 2019

Category: Facade

Product: Solid S 191

Equivalent product: Zenor



Flygvapenmuseum Linköping, Sweden

Architect: White Arkitekter
Type: Museum
Year: 2012
Category: Facade
Product: Cembrit Cover in
NCS 8500-N (discontinued)
Equivalent product: Planea



Fladstrandsparken Frederikshavn, Denmark

Architect: Lumo Arkitekter &
Prisme Arkitekter

Type: Residential

Year: 2014

Category: Facade

Product: Solid S 070, S 191,
S 212 and S 353

Equivalent product: Zenor



The Forest Glesborg, Denmark

Architect: Arkikon

Type: Private housing

Year: 2014

Category: Facade

Product: Cembrit Transparent T 111 (discontinued)

Equivalent product: Carat



Stockholm Fashion District, Sweden

Architect: Studio Stockholm
Type: Public
Year: 2016
Category: Interior
Product: Swisspearl Patina Original P 070, Cembrit Windstopper Extreme

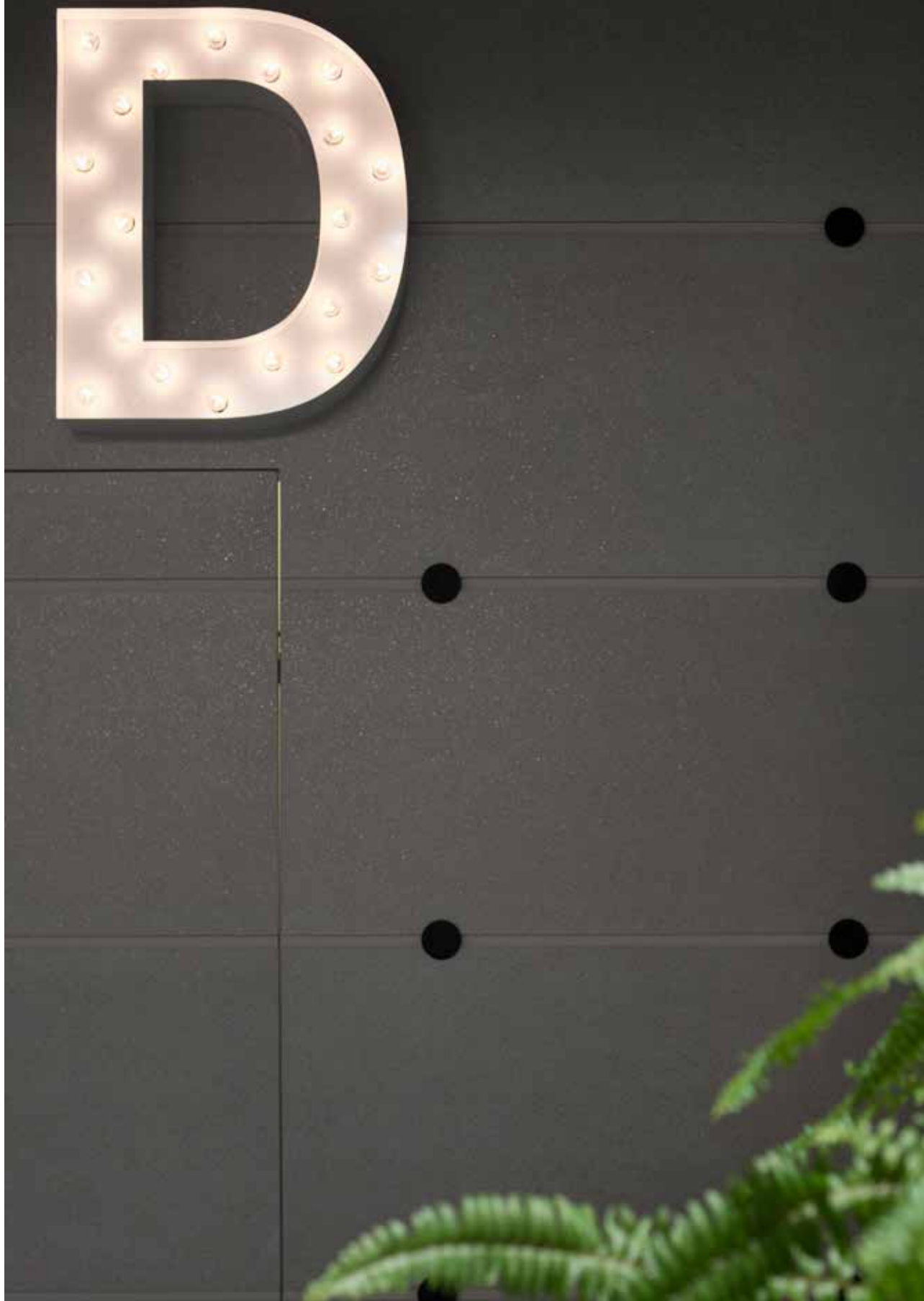

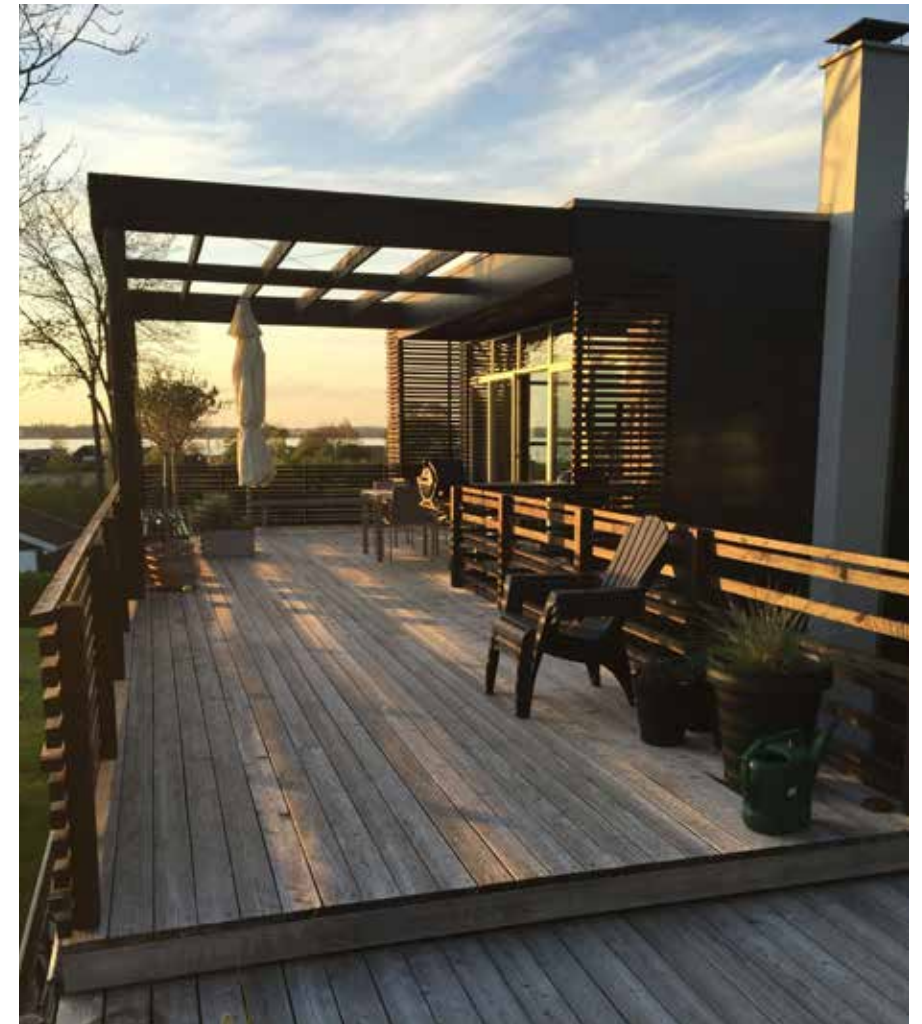

Strib - Denmark

Architect: Harald og Jane Husted Sørensen

Type: Private housing

Year: 2016

Category: Facade

Product: Solid S 191

Equivalent product: Zenor



Valhall BRL Oslo, Norway

Architect: 4B Arkitekter

Type: Residential

Year: 2015

Category: Facade

Product: Swisspearl Patina Original

P 050 and P 222



Villa Näverkärr Slävik, Sweden

Architect: Fahlander Arkitekter
Type: Private housing
Year: 2012
Category: Facade
Product: Swisspearl W 177-6 natural grey



Kåkenäs Stenungsund, Sweden

Architect: White Arkitekter

Type: Private housing

Year: 2015

Category: Facade

Product: Swisspearl Patina Original

P 222



M/S Røj Bohuslän, Sweden

Architect: Koch

Type: Private houseboat

Year: 2016

Category: Facade

Product: Swisspearl Patina Original

P 020, P 070 and P 222



Restaurant Skovbakken Aalborg Zoo, Denmark

Architect: KPF Arkitekter

Type: Public building

Year: 2009

Category: Facade

Product: Swisspearl Patina Original P 070





Skönsmons skola - Sundsvall, Sweden

Architect: Sweco Architects

Type: School

Year: 2019

Category: Facade

Product: Swisspearl Patina Original P 070 and P 545



Skafjellåsen Sande, Norway

Type: Residential

Year: 2018

Category: Facade

Product: Swisspearl Patina Original
P 050, P 545 and P 656



Yes, we create first class fibre-cement products.

But we're much more than that.

What we do, we do for people. For the architects, builders and construction professionals who work with our products to bring their imagination to life. And for those who live with and enjoy the final result – a beautifully designed home or a convenient office space.

We are always ready to share our know-how to help you achieve more in every aspect of your particular projects.

If you've enjoyed what you've seen in this book, feel free to explore more inspiration.

swisspearl.com



